

STEVENAGE SPORTS & LEISURE CENTRE

A NEW SPORTS & LEISURE CENTRE FOR STEVENAGE

WELCOME

Welcome to this exhibition giving a first look at exciting plans for a new Sports & Leisure Centre for Stevenage. The proposed new facility will bring together the sports and swimming facilities currently provided at Stevenage Arts & Leisure Centre and Stevenage Swimming Centre.

STAKEHOLDER ENGAGEMENT
NOVEMBER 2024

WHAT'S THE PLAN FOR THE NEW CENTRE?

The vision is for a modern, purpose-built, state of the art facility encompassing a swimming pool, studios, and gym space with flexible sports and leisure facilities including soft play. There will also be a café with access from Town Centre Gardens. Having combined swimming and leisure facilities all under one roof will not only improve the customer experience, it will also help to reduce maintenance costs, provide a more efficient use of space and reduce the town's carbon footprint.

WHY ARE WE DOING THIS?

The existing Sports & Leisure Centre facilities, including the current swimming pool, are well used but were designed and built in the 1960s and 70s. The buildings are ageing and do not provide the flexibility or modern experience for users. This is an opportunity to modernise the facilities and provide ease of access with multiple uses in a single location.

HOW ARE WE PAYING FOR THIS?

The project will be partially funded through the Government's Towns Fund. The Stevenage Development Board secured £37.5m in March 2021, of which £10m will be used for this new facility.



Existing Stevenage Swim Centre



Existing Stevenage Arts & Leisure Centre

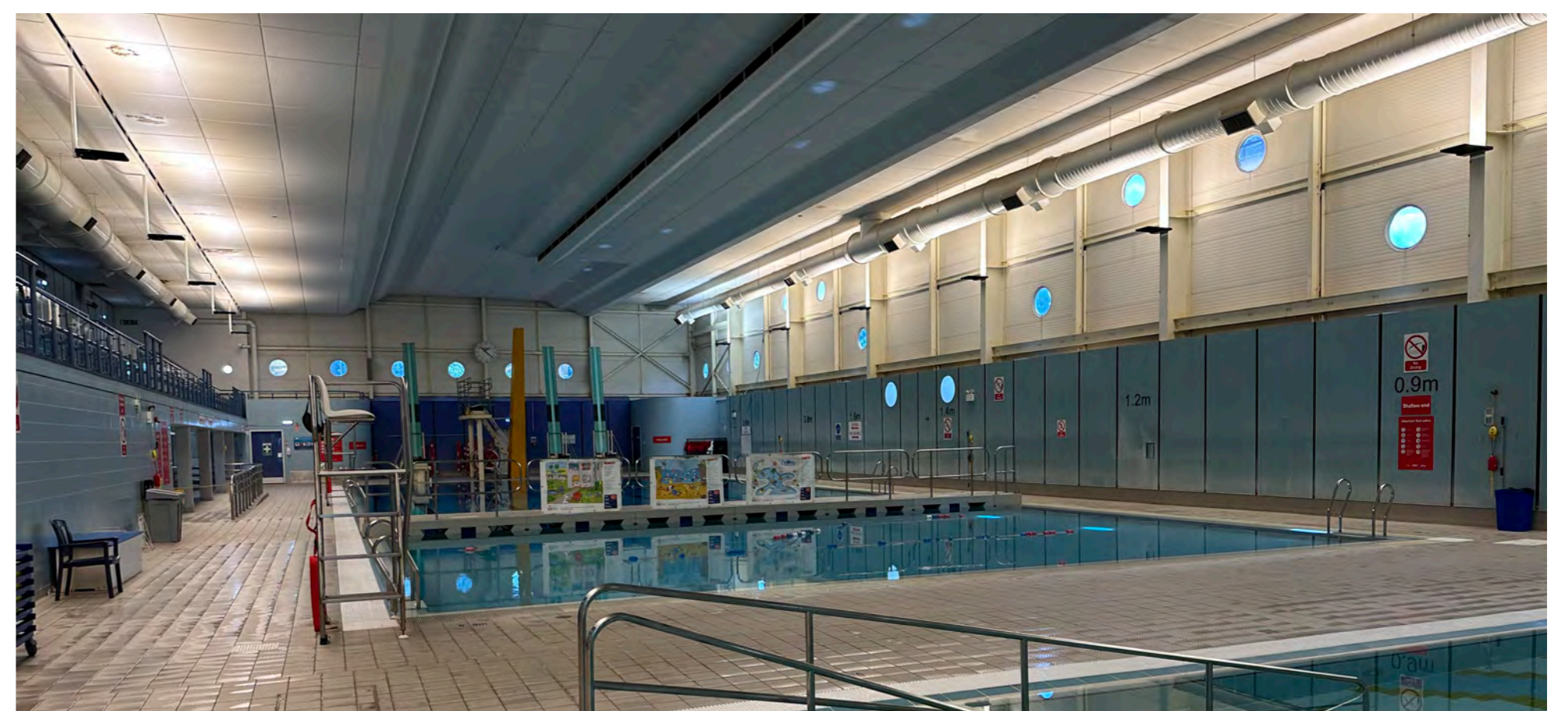

Existing Stevenage Swim Centre



Artist Impression - New splashpad facilities with visual connection to the cafe and nature



Artist Impression - New training pool facilities with visual connection to the cafe and nature

PLEASE HAVE A LOOK AT THE BOARDS AND ASK THE MEMBERS OF THE TEAM IF YOU HAVE ANY QUERIES!

YOU SAID, WE DID ENGAGEMENT SO FAR

ENGAGEMENT TO DATE

The council is committed to continue working alongside the local community on a facility that will offer something for everyone.

At the end of last year, we asked residents, communities and businesses to share with us what they wanted to see in a new facility. Whilst we will be unable to deliver everything, we have incorporated your feedback, where possible.

YOU SAID

WE DID



Modern building in an accessible location



- Modern building with sustainable features.
- In a prominent location accessible by foot, bike, and car, with parking nearby and a new pedestrian crossing across St George's Way.



Accessible for all with a wide range of facilities



- Fully accessible building - compliant with all modern regulations.
- There are a mix of facilities in response to feedback from previous consultations.



Family friendly with activities for all ages



- New studios will offer flexible use - allowing a wide range of classes and activities.
- Soft play provision.



Wellbeing



- Sauna and steam facilities.
- The Healthy Hub will relocate to the new building.



A bigger pool and interactive water play



- A 10 lane, 25m pool will have a moveable floor to allow for depth variation.
- A large teaching pool and interactive splashpad are included.



Space for classes and indoor sports



- Three dedicated studio spaces, a spin studio, 200 station gym with Town Centre Gardens views and an indoor sports hall to allow for a range of activities.



A café



- Café that will interact with the Town Centre Gardens offering outdoor seating.



Safe pedestrian access



- Pedestrian access is a priority with a pedestrian crossing being introduced as part of the new science development opposite the new facility. This allows a safe route in addition to the underpasses plus access through the Town Centre Gardens.



Parking: vehicles, blue badge spaces and bikes



- Parking will be provided with blue badge spaces as well as cycle parking and coach drop off points.



Artist Impression - Approach to the Sports & Leisure Centre



Artist Impression - State of the art gym facilities



Artist Impression - Provision of four new studios

PLEASE LOOK AT THE NEXT BOARDS FOR FURTHER INFORMATION.

A MODERN, STATE OF THE ART BUILDING

THE SITE

LOCATION

The new Sports & Leisure Centre will have a strong physical and visual connection with the Town Centre Gardens to the east and excellent connectivity to the town centre in the west. A new pedestrian crossing on St George's Way will enhance the visitor experience by creating an urban corridor that connects the town centre, the new Life Sciences Quarter and the Sports & Leisure Centre.

POINTS OF REFERENCE

- 1 Stevenage Sports & Leisure Centre
- 2 Sports & Leisure Centre parking
- 3 The Forum development (to be constructed)
- 4 Town Centre Gardens
- 5 Bowes Lyon Young People's Centre
- 6 St George's Way Multi-Storey Car Park
- 7 Town Square
- 8 Westgate Shopping Centre
- 9 Autolus Therapeutics

ACCESS TO THE NEW SPORTS & LEISURE CENTRE

- 10 Entrance and exit to the facility
- 11 New pedestrian crossing
- 12 Underpass connection



Artist Impression - Connection between cafe/pools, and Town Centre Gardens

Artist Impression - Connection between reception and Town Centre Gardens

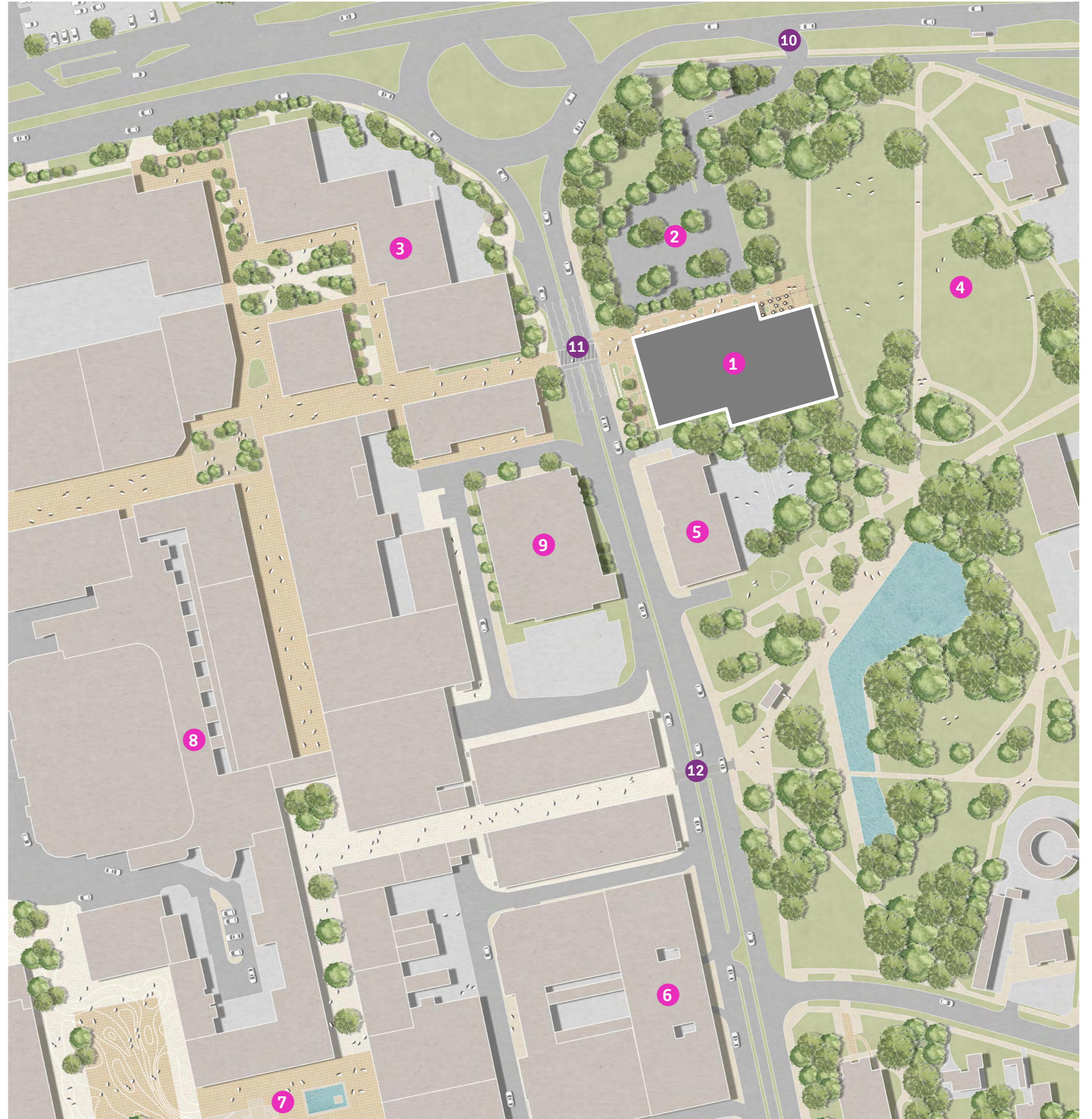

Vision site plan highlighting connection to the town centre and Town Centre Gardens

Site diagram

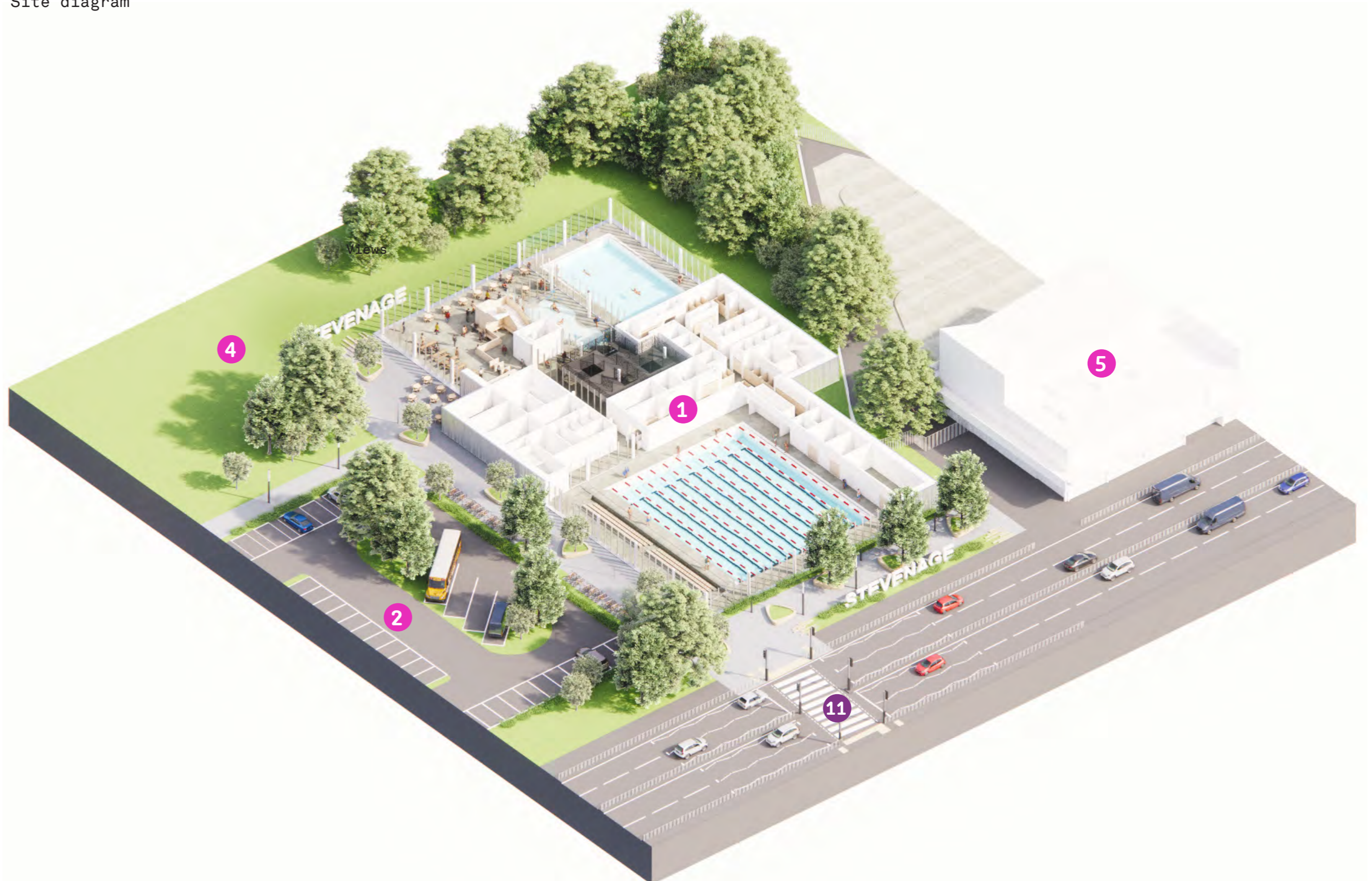

FACILITIES FOR EVERYONE INSIDE THE BUILDING

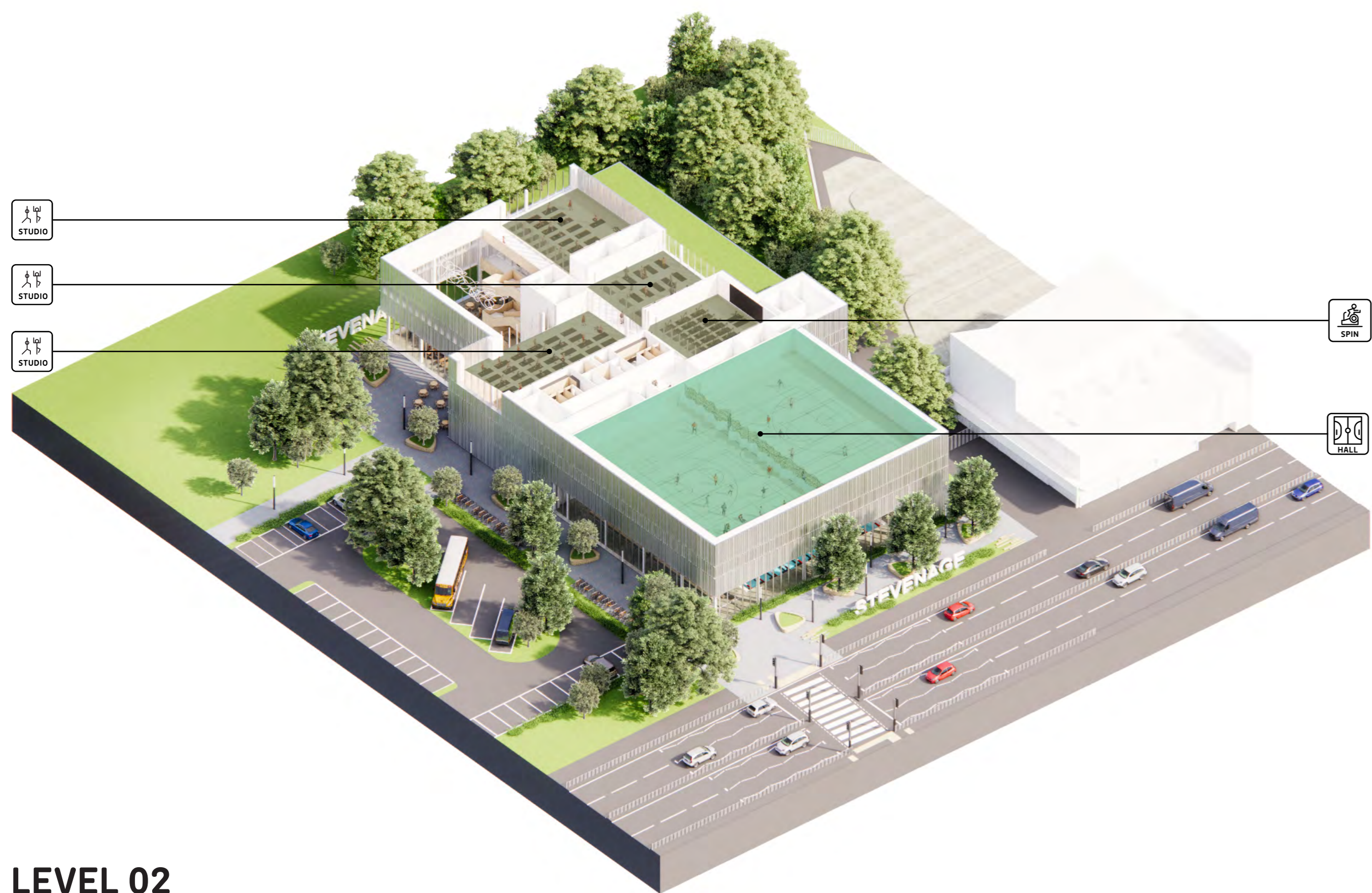

LEVEL 02

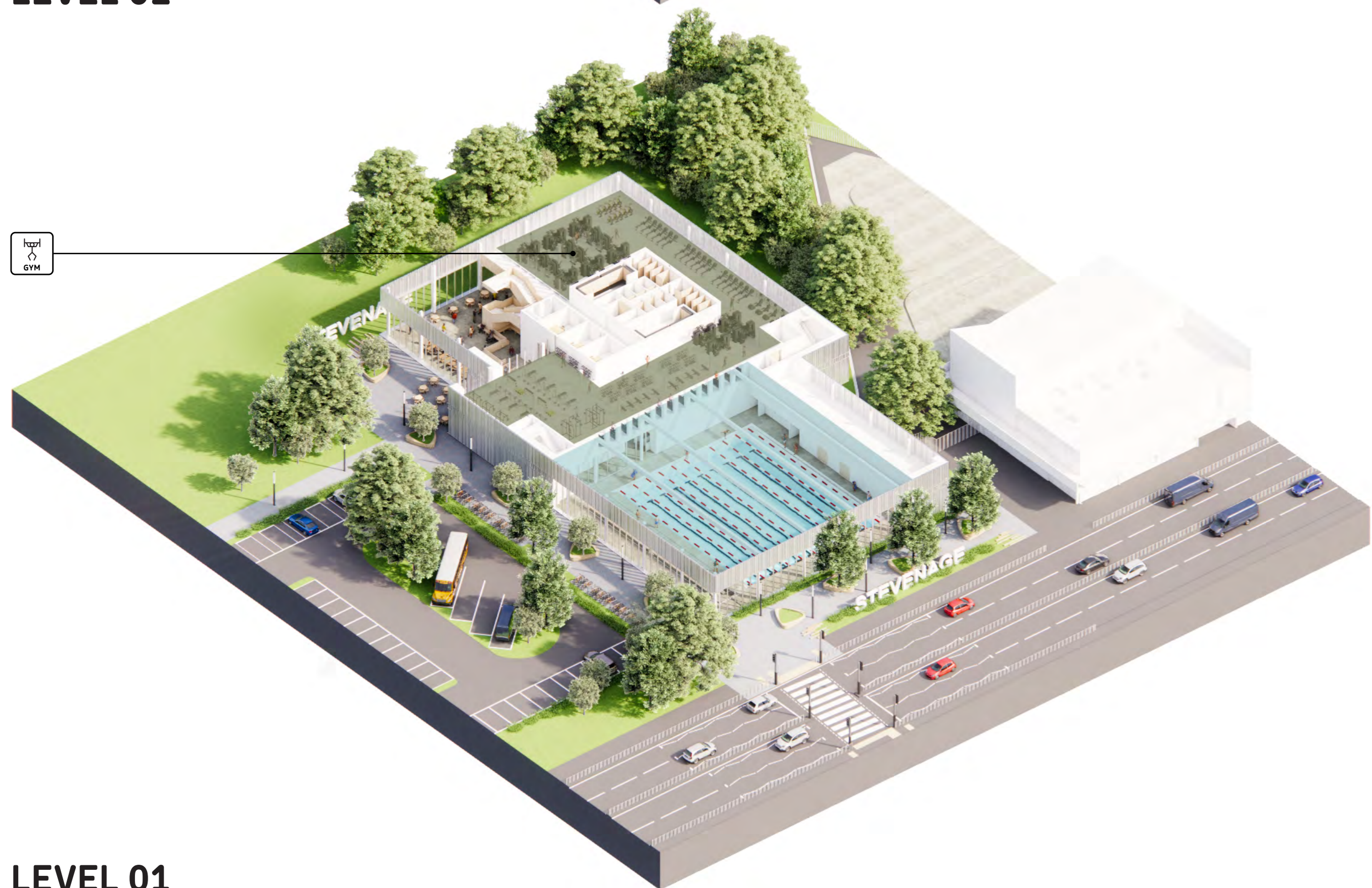
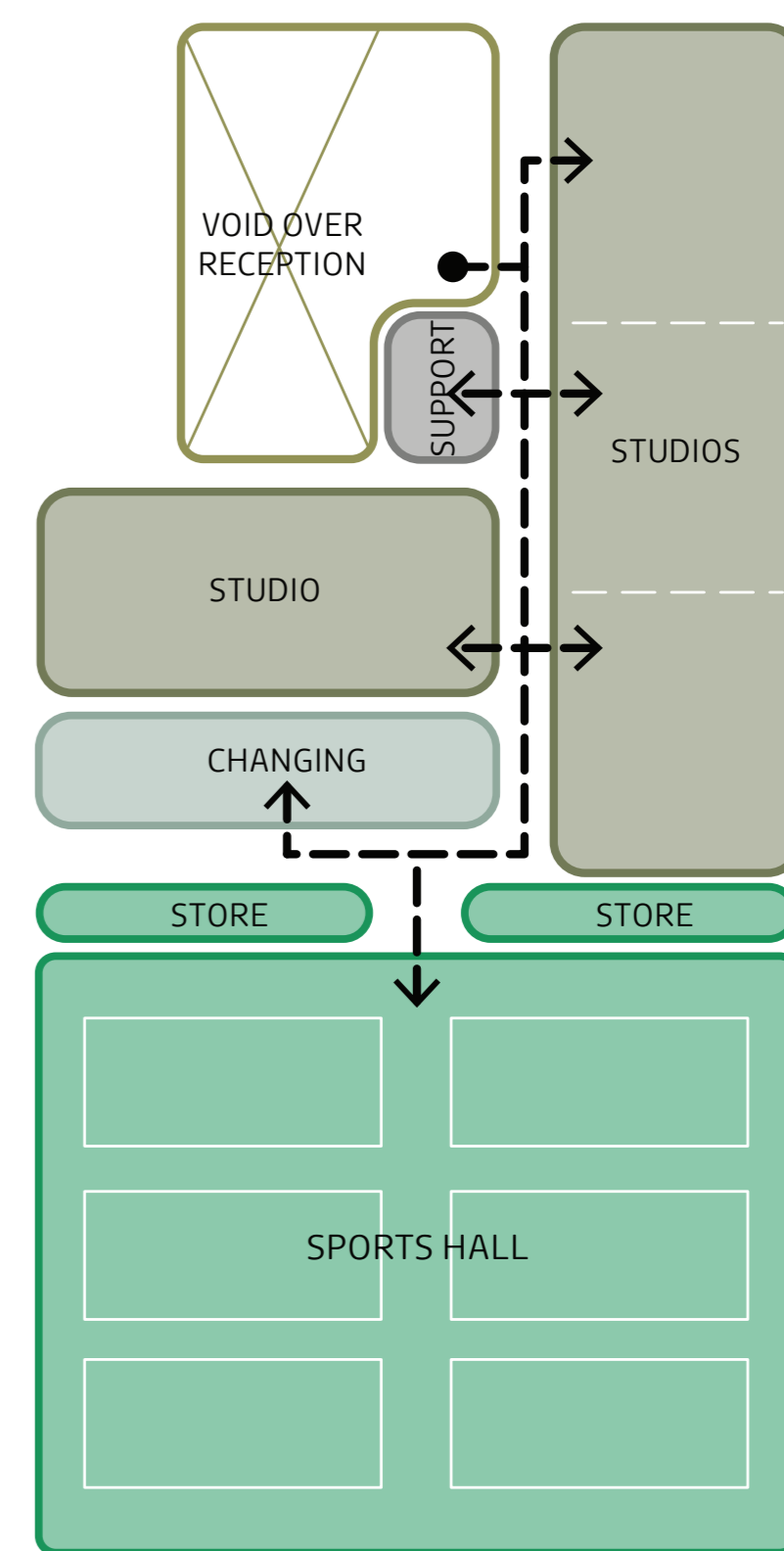

LEVEL 01

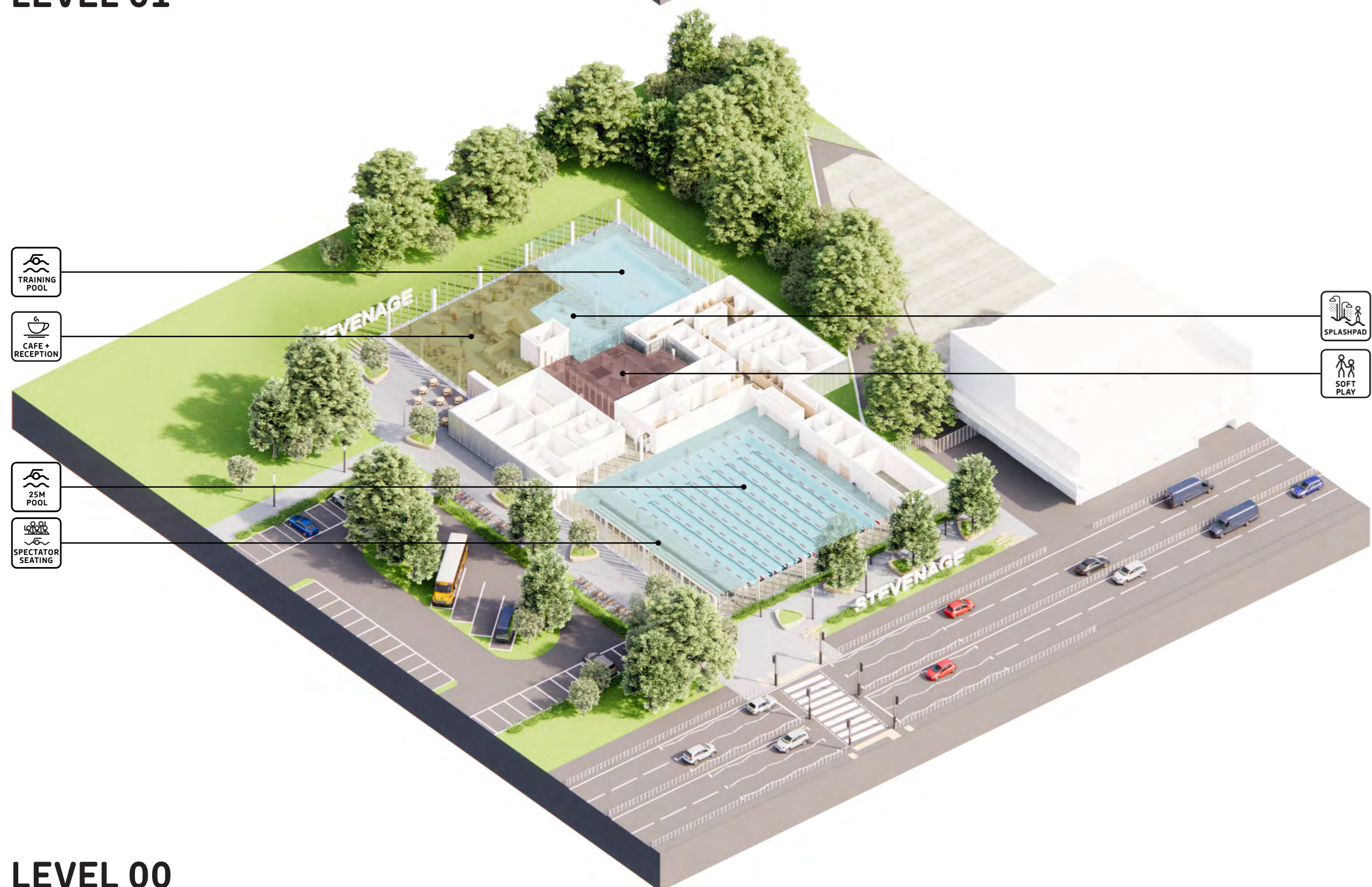
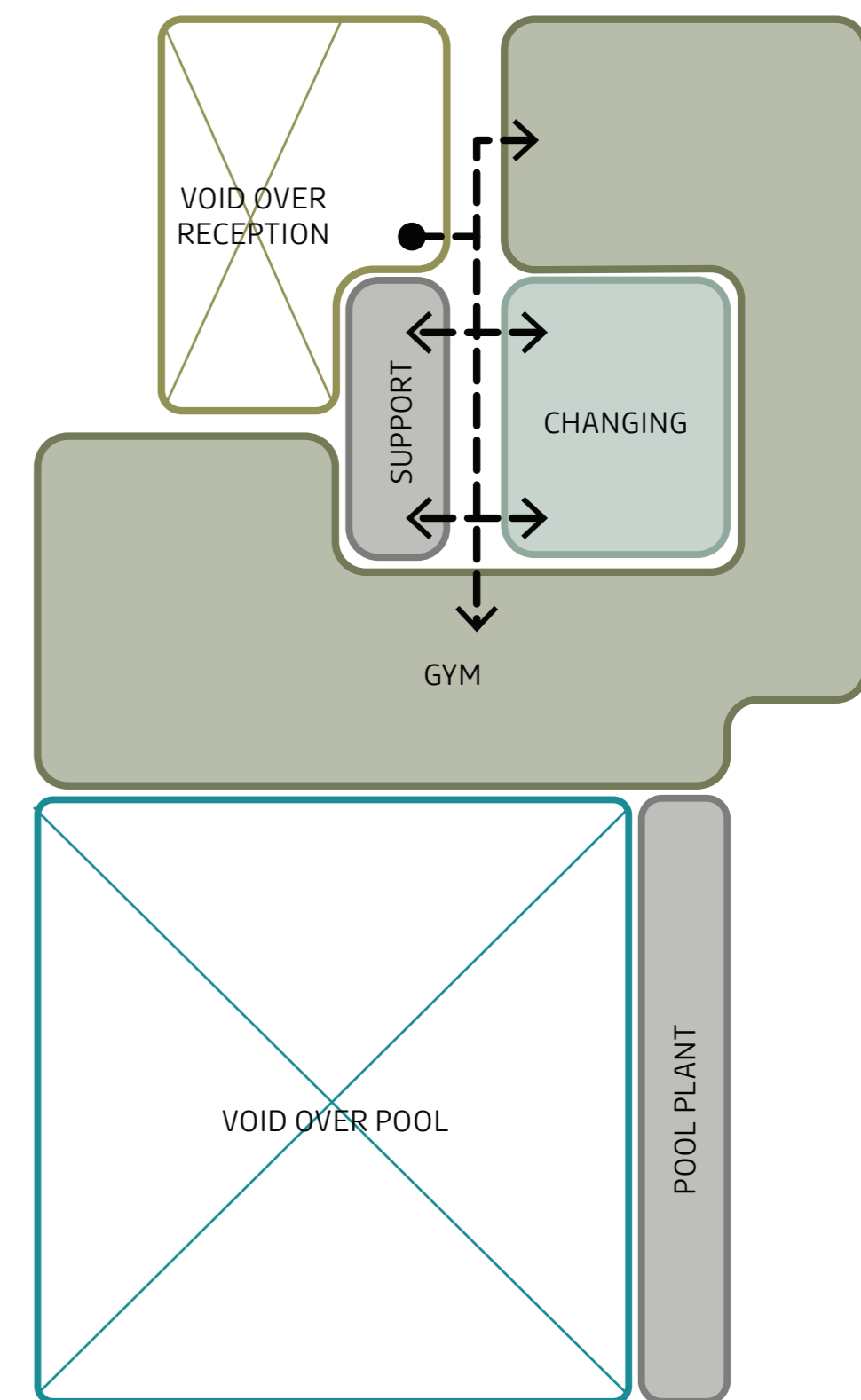

LEVEL 00

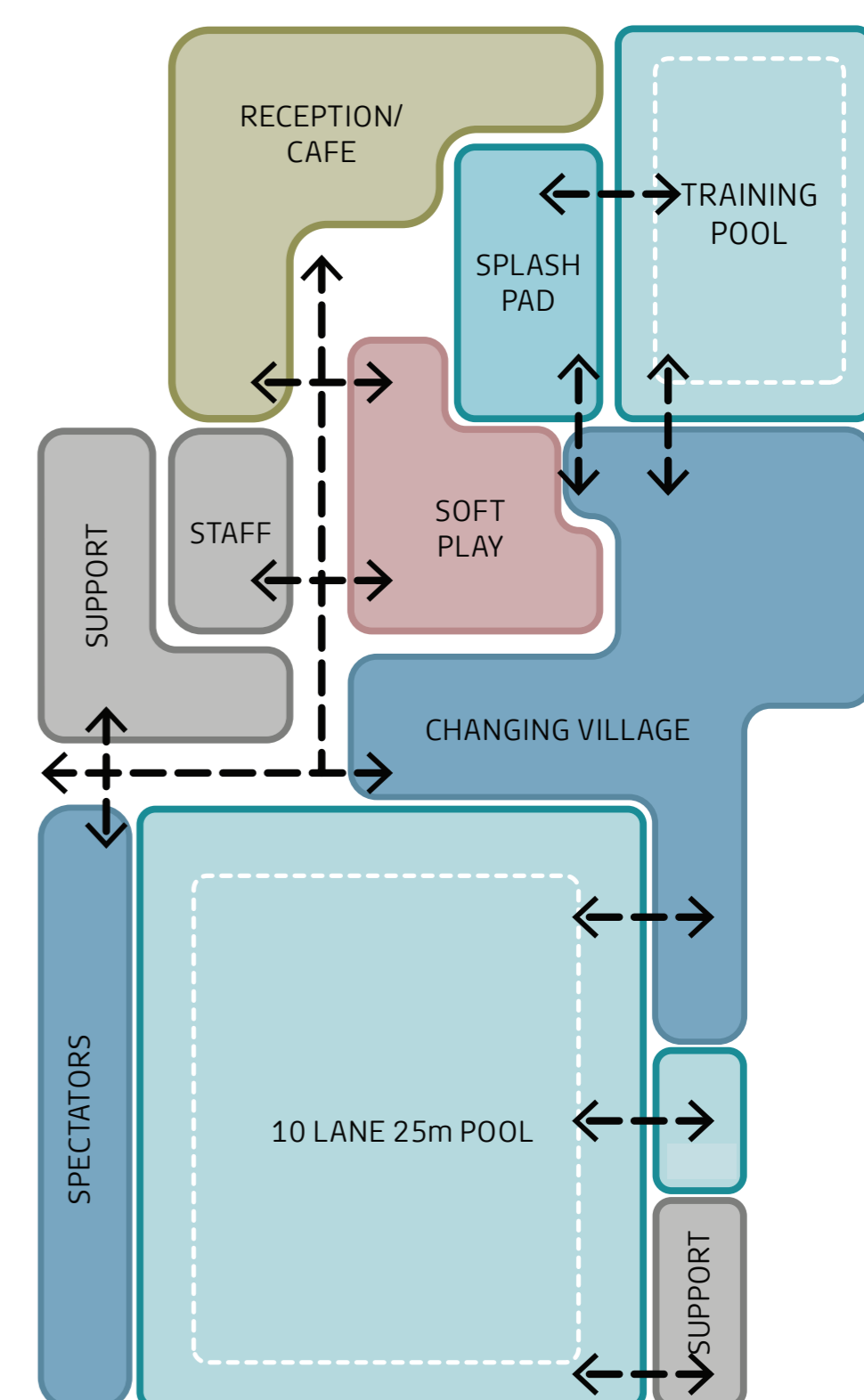

ENVIRONMENTALLY CONSCIOUS SUSTAINABILITY

THE AMBITION

The new Sports & Leisure Centre aspires to be a model for sustainability, with eco-friendly features throughout the design and its operation. We will be seeking sustainable building materials such as recycled materials and renewable energy sources such as solar panels. Active travel is encouraged with bike parking and electric vehicle charging points provided.

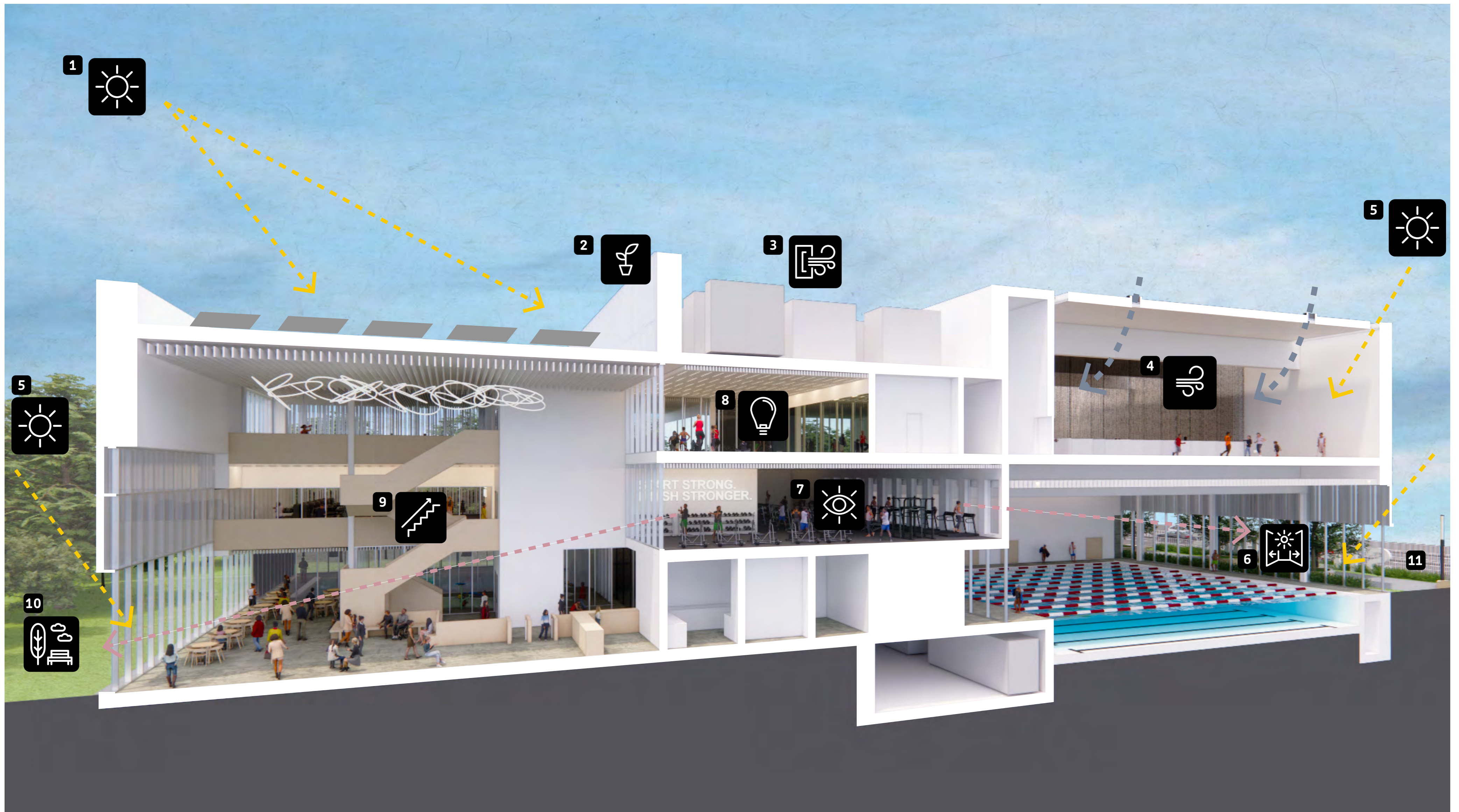

Building in section showing sustainability features

KEEPING IT GREEN

1. Solar panel installation.
2. Green roof options and the ability to recycle rainwater.
3. Fossil-fuel free: air source heat pumps to power heating and hot water.
4. Natural ventilation to sports hall.
5. Natural light to key spaces in the building including pool areas, reception and café
6. High performance window glazing to maximise external views.
7. Views to the outside from as many spaces as possible.
8. High-efficiency LED lighting.
9. Encouraging the use of the stairs with a bold and open design.
10. Connect to the park to improve walking routes around the site and to the town centre.
11. Bicycle parking.

Sheffield cycle hoops



Solar panels



Artist Impression - Natural light

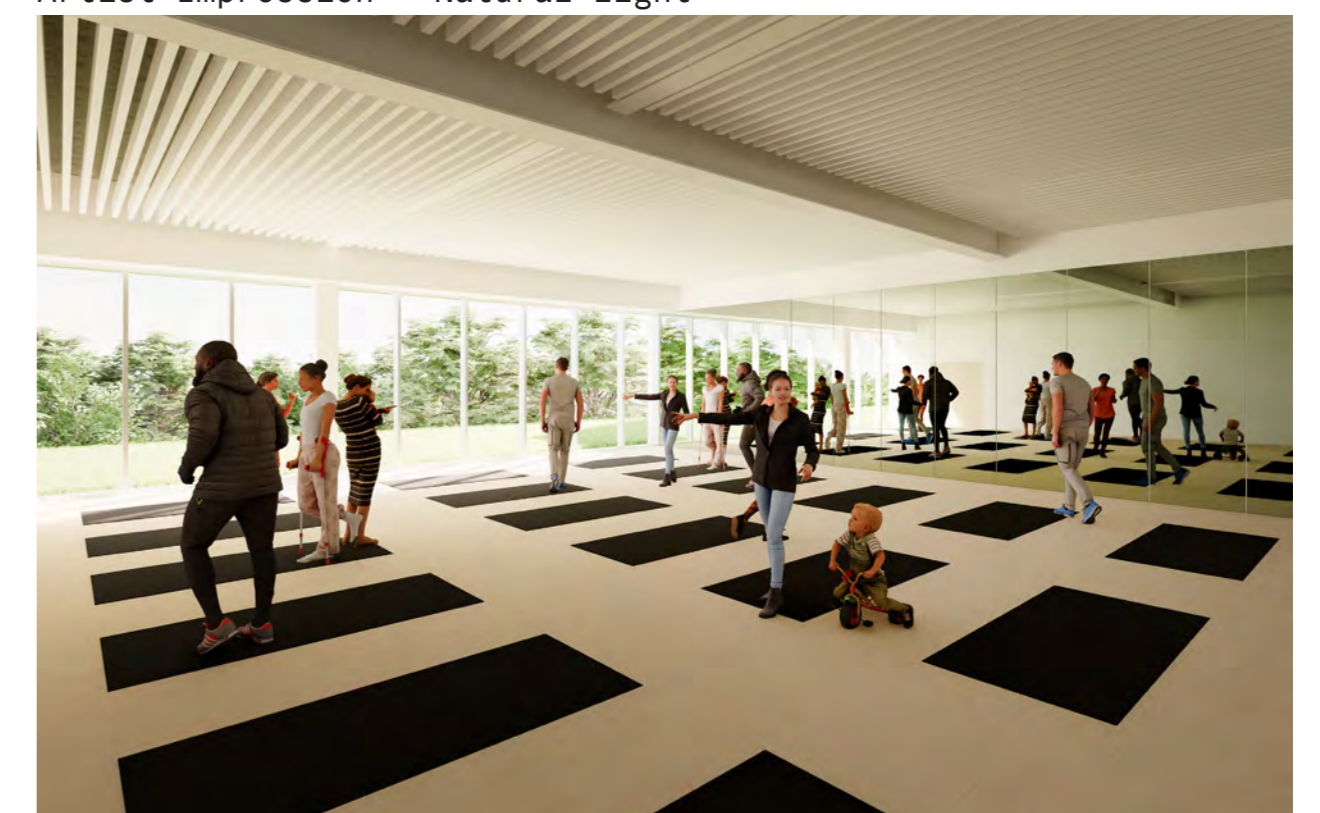

ACCESSING THE BUILDING

ACCESSIBILITY FOR ALL

Physical activity, sports and leisure is good for us all. It benefits physical and mental health and can improve quality of life, improve mood and enhance general wellbeing.

One of the key priorities for Stevenage's new Sports & Leisure Centre is to make it as accessible and inclusive as possible. The building will be designed in line with modern day accessibility standards, and will include:

FACILITIES FOR PEOPLE WITH HEARING DIFFICULTIES

— Hearing aid induction loops will be provided at key locations throughout the site.

DEMENTIA FRIENDLY DESIGN

— The design of the new facility will ensure it is as safe and easy as possible for people with dementia to navigate. For example, using colour to designate location.

ENTRANCES, STAIRS, RAMPS AND LIFTS

— Access to the building is at ground floor and will provide level access to the facility.
 — All lifts will be suitable for wheelchair users, double buggies, and those with mobility needs.
 — All stairs and ramps will be designed in accordance with current legislation.

ACCESS TO TOILETS AND CHANGING ACCOMMODATION

— A ground floor changing facility will include full cover tracking hoists with easy access to all pools, and in close proximity to the public café space and lifts to other facilities on Level 1 and 2.
 — A range of accessible changing rooms, toilets and cubicles are incorporated to ensure equitable access for all user needs.

ACCESS TO POOLS

— Poolpods will facilitate a choice of access options to the pools.
 — Movable pool floors will help cater for a wide range of user demographics and needs.
 — Special Educational Needs (SEN) multi-sensory equipment will be included for the teaching and splashpad areas.

PERSONAL STORAGE

— Wheelchair-accessible lockers will be provided in line with Sport England guidance alongside full height lockers for storage of walking aids.
 — Storage space for buggies is also provided.

SITE-WIDE ACCESS STRATEGY

Inclusive access standards and regulations will be adopted throughout the scheme. They include:

— A new surface level crossing from St George's Way for on-foot visitors accessing the building.
 — A dedicated car park with blue-badge parking.
 — Cycle parking connecting to the Town Centre Gardens.

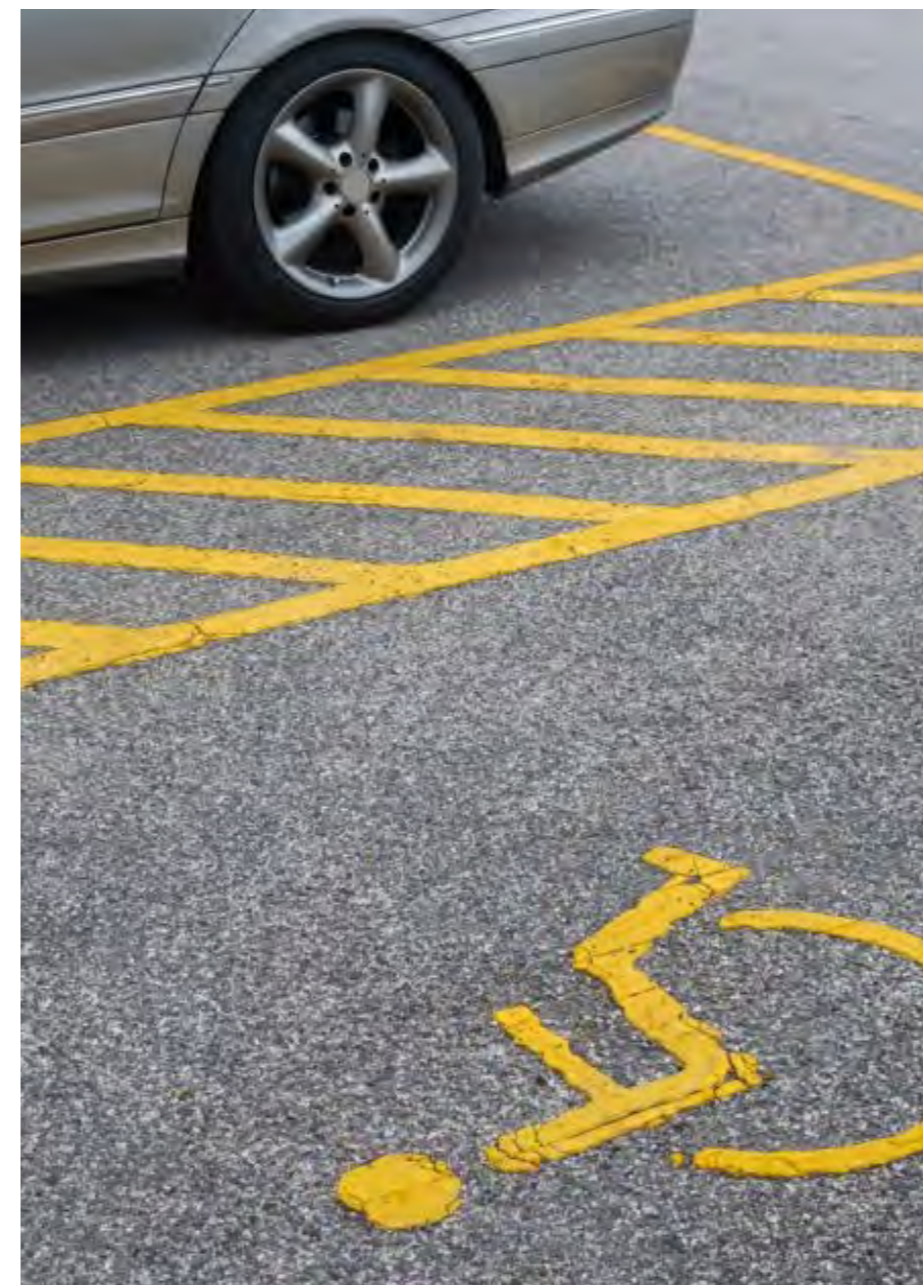

Blue badge parking

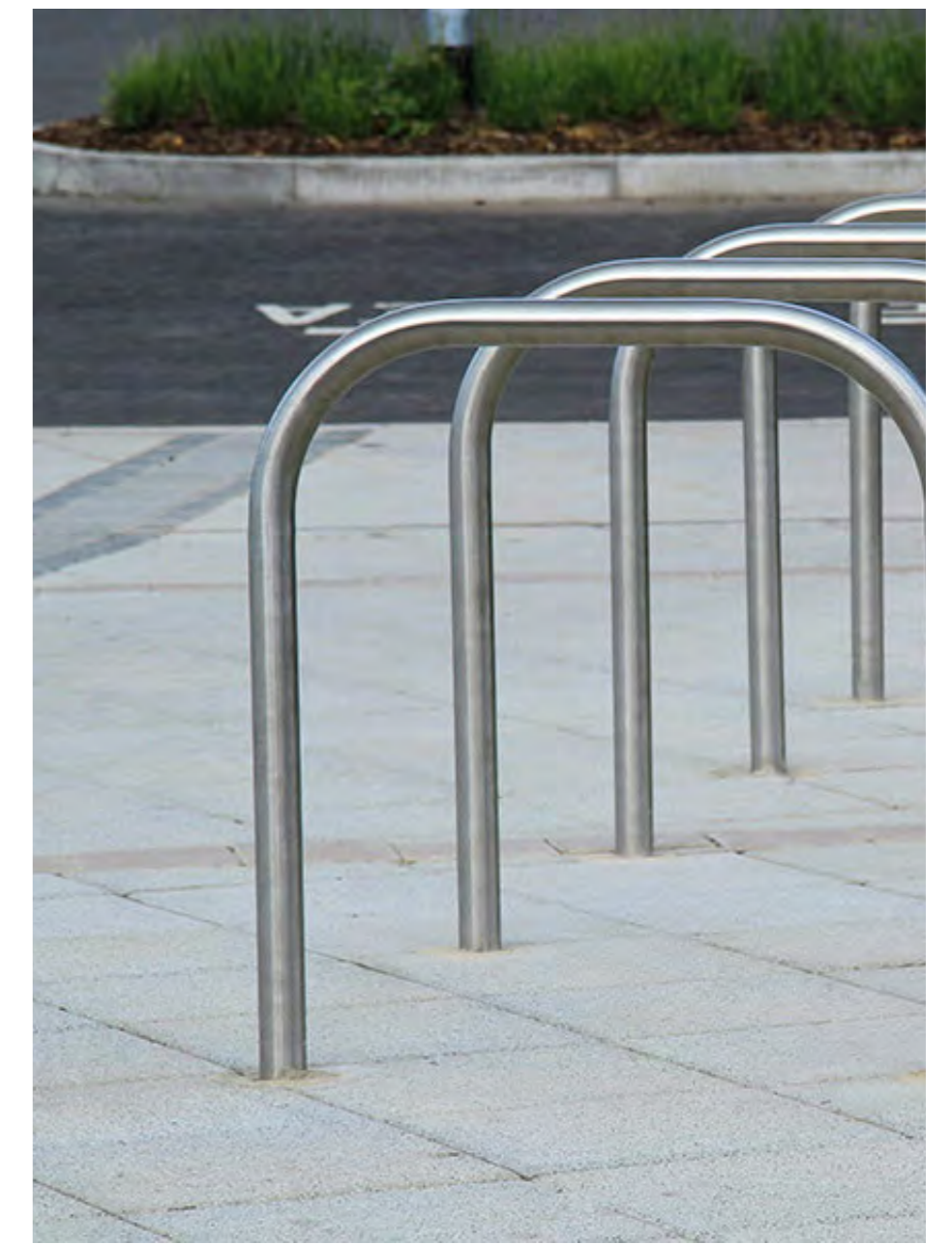

Cycle parking



Artist Impression - Accessible dry sports

Accessible wet facilities - Poolpod



Accessible Changing Places

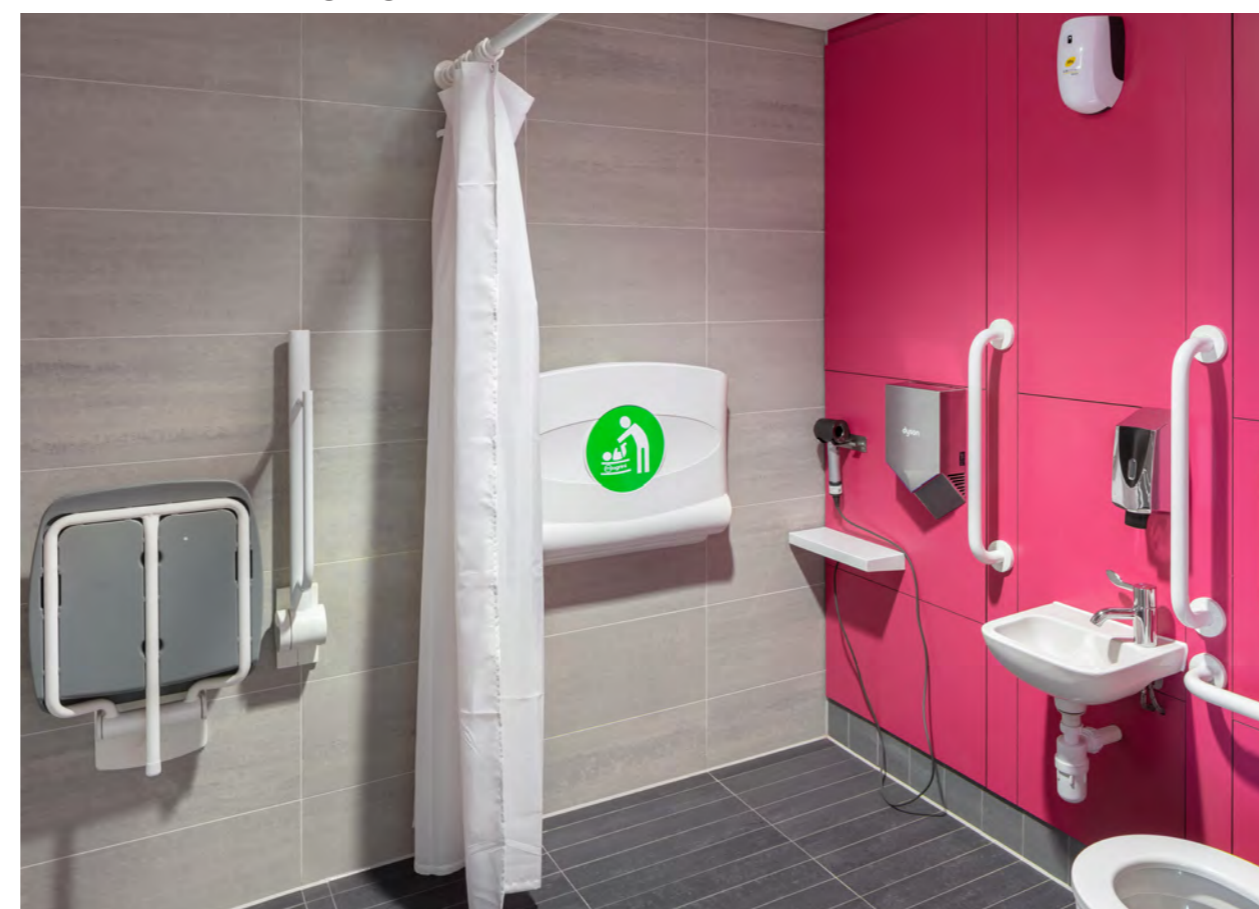

Hearing aid technology



NEXT STEPS

KEEPING STEVENAGE SWIMMING CENTRE OPERATIONAL



Artist Impression - Entrance atrium

OUR COMMITMENT

The Swimming Centre and Arts & Leisure Centre will remain operational throughout the construction of this new building. The Gordon Craig Theatre is unaffected by this plan.

HAVE YOUR SAY

The Council is committed to continue working alongside the local community on the new Sports & Leisure Facility that will offer something for everyone.

Your feedback is important to us and we encourage you to leave your thoughts.

You can do this by:

- Completing the hard copy form available today;
- Visit the Stevenage Even Better website to view the proposals and leave your views using our online form:
<https://stevenage-even-better.com>
- Closing date for comments is Friday 6th December 2024 at 5pm.

DEVELOPMENT TIMELINE

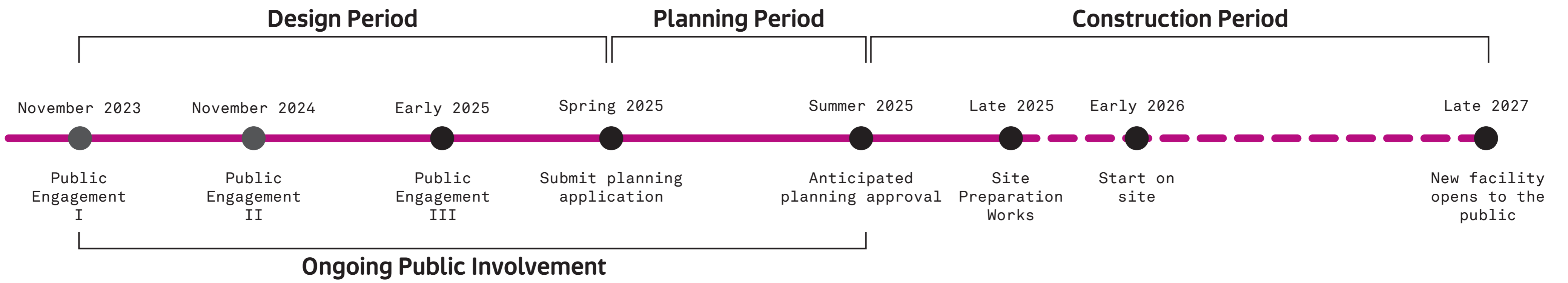

Artist Impression - 25m 10 lane swimming pool

